

July 15, 2019

Department of Sustainable Development  
Environmental Approvals Branch  
Box 80, 160-123 Main Street  
Winnipeg, MB R3C 1A5  
204.945.2614

**Attention:** Asit Dey, P.Eng., Environmental Engineer

**Reference:** New Rosedale Colony Lagoon - EAL 3198 File 5838.0

**Subject:** Letter of Certification

Dear Asit:

I Daniel Burns, P.Eng. hereby certify that I or another suitably qualified person reporting to me have completed periodic reviews at appropriate stages of the civil/environmental aspect of construction for the lagoon located at the New Rosedale Colony Site located on NW 16-18-11 WPM. For further details of the scope of work, please refer to "New Rosedale Colony Lagoon Design NW 16-18-11 WPM" Drawings dated July 27, 2016.

Please see below our response to the email issued by Mr. Asit Dey, P.Eng. to Mr. Daniel Burns, P.Eng. and Mr. Ryan Johnston, P.Eng. of Burns Maendel Consulting Engineers Ltd. (BMCE) on October 17, 2016 regarding the interim authorization of the New Rosedale Colony lagoon and outstanding requirements for approval:

1. *"During our inspection, it was noticed that the vents were connect to the vent pipes by friction fit. It was our understanding that they will be glued together."*

BMCE advised the contractor of this outstanding item. A site inspection was conducted on May 11, 2017 confirming the vents were glued to the venting pipes.

2. *"Mr. Johnston was also informed to consider incorporating a non-slip walkway along with suitable handrail from the outermost edge of the liner on the perimeter berm of the wastewater lagoon up to the location of the valve. We are aware that textured HDPE liner material was used for this project. I have discussed this issue with our team and it is of our opinion that a nonslip walkway and suitable handrail are required as a safety measure to prevent accidental falls where common berms are wrapped under plastic liners. Please update your NoA submissions accordingly."*

BMCE proposed an alternate remedial design for the center berm of the lagoon (refer to email issued to Mr. Asit Dey, P.Eng. on November 16, 2016) in which the liner would be covered with a 6ox geotextile fabric and 4 inches of A-Base granular from the outermost edge on the north side of the berm to the valve box on the center berm. The proposed alternate remedial design was verbally approved by Mr. Dey via telephone on November 23, 2016. BMCE performed a final site inspection on May 8, 2019 confirming the quality and installation of the geotextile and A-Base granular, see Record Drawings attached in Appendix A for further details.

In my professional opinion the construction was carried out in substantial compliance with the applicable provisions of The Environment Act regulations and Manitoba Sustainable Development (MSD) guidelines, and the plans submitted by BMCE, issued July 27, 2016 by Daniel Burns, P.Eng. I have informed MSD in cases I am aware that the construction has deviated from the submitted plans; see attached Record Drawings. I am not aware of any substantial workmanship, materials, or assemblies that would compromise specification requirements.

Testing procedures and documents required for approvals, other than those specified in this Letter of Certification, have been conducted in accordance with applicable MSD requirements and submitted/approved previous to the issuance of this Letter. As such, they have not been included with this submission.

I trust that this Letter of Certification has addressed the requirements of the MSD. However, should you require additional information or further clarification please do not hesitate to contact the undersigned at 204-728-7364.

Yours truly,  
BURNS MAENDEL CONSULTING ENGINEERS LTD.



Daniel Burns, P.Eng.  
Civil Engineer

Cc: Jerry Maendel – New Rosedale Colony



## Appendix A – Record Drawings

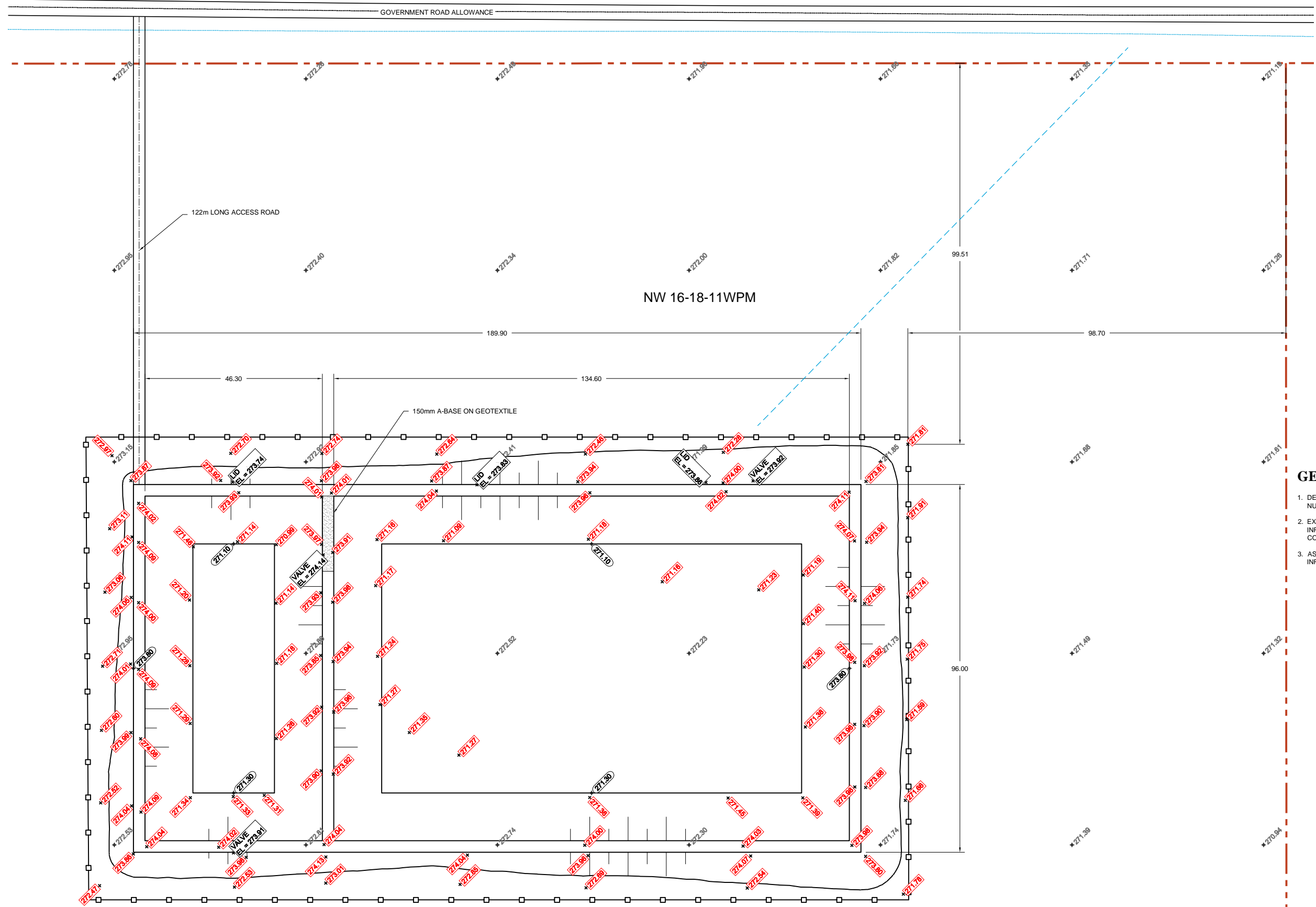

- GENERAL NOTES**
1. DECIMALIZED NUMBERS INDICATE METRES AND WHOLE NUMBERS INDICATE MILLIMETRES.
  2. EXISTING FEATURE LOCATIONS & PROPERTY LINE INFORMATION IS DERIVED FROM SURVEY INFORMATION COLLECTED BY RICHMOND SURVEYS.
  3. AS BUILT ELEVATIONS ARE DERIVED FROM SURVEY INFORMATION COLLECTED BY BMCE ON NOV 14, 2019.

**LEGEND**

PROPERTY LINE	---
AS BUILT FENCELINE	—
PROPOSED CULVERT / EXTENSION	—○—
DITCH / SWALE	- - - -
GRADE SLOPE w/ DISTANCE	2.00%
EXISTING GROUND ELEVATION	+100.00
PROPOSED GROUND ELEVATION	-(100.00)
AS-BUILT ELEVATION	-(100.00)

0	JULY 4, 2019	D.B.	J.K.	RECORD DRAWING
NO.	DATE	APP.	BY	DESCRIPTION
REVISIONS				

**RECORD DRAWING**  
AS BUILT CONSTRUCTION

**APECM**  
Certificate of Authorization  
Burns Maendel Consulting  
Engineers Ltd.  
No. 4559 Expiry: April 30, 2020



DESIGNED BY: C1.1  
REVIEWED BY: D.B.  
DRAWN BY: J.K.  
PROJECT START DATE: NOV 2015  
PLOT SIZE: A1 (594x841)  
SCALE: 1:1000

PROJECT NAME:  
**NEW ROSEDALE COLONY  
LAGOON DESIGN  
NW-16-18-11 WPM**

**BURNS MAENDEL  
CONSULTING ENGINEERS LTD.**  
1331 Princess Ave.  
Brandon, Manitoba  
R7A 0R4  
Tel: (204) 728-7364  
Fax: (204) 728-4418

DRAWING TITLE:  
**LAGOON AS-BUILT PLAN**

PROJECT NUMBER: **BMCE14-166-36**  
DRAWING NO: **C1.1**